

DUNLOP PAWA 44kVA

50Hz 1500RPM 35kW/44kVA

General Features

- Low noise/super silent canopy design
- Forklift pockets available
- Residential silencer with flexible exhaust pipe
- MCCB & maintenance-free starting battery
- External fuel inlet, coolant drain, oil drain
- External power outlet distribution available
- Bunded base with 24-hour base fuel tank @75% load
- 50°C Radiator as standard spec;
- Radiator fan is driven by belt with safety guard
- Vibration isolators between engine/alternator and base frame
- All-round protection functions and safety labels
- User manual of engine, alternator, controller



Generator Ratings

Voltage	HZ	Phase	P.F (COS ϕ)	Prime Amps	Prime Ratings(kW/kVA)	Standby Ratings(kW/kVA)
380/220	50	3	0.8	61	32/40	35/44
400/230	50	3	0.8	58	32/40	35/44
415/240	50	3	0.8	56	32/40	35/44

- Prime Power: Continuous running at variable load for unlimited periods;
10% overload available for 1 hour in every 12 hours.
- Standby power: Continuous running at variable load in the event of a utility power failure;
No overload is permitted on these ratings.

Sales Promise

DUNLOP provides a full line of brand new and high quality products.

Each unit is strictly factory tested before delivery.

Warranty is according to below standard conditions, subject to the earlier one:

- 12 months after shipment
- 1000 accumulated running hours

Service and parts are available for the generator life time from **DUNLOP**.

Engine

Manufacturer / Model	DCEC/4BT3.9-G1
Air Intake System	4 Cycle, Turbocharged
Fuel System	BYC A/RSV Mechanical
Number of Cylinders / Cylinder Arrangement	4 in Line
Displacement (L)	3.9 L
Bore × Stroke (mm × mm)	102×120
Compression Ratio	117.3:1
Rated Speed (RPM)	1500
Standby Power @ Rated Speed (kW)	40
Speed Governor	Mechanical/Electrical
Fuel Consumption @ 100% Load (L/h)	10.0
Fuel Consumption @ 75% Load (L/h)	7.9
Fuel Consumption @ 50% Load (L/h)	5.9
Fuel Consumption @ 25% Load (L/h)	4.0
Total Oil Capacity (L)	10.9
System Voltage (V)	DC 12

Alternator

Compliance with GB755, BS5000, VDE0530, NEMAMG1-22, IED34-1, CSA22.2 and AS1359

Exciter Type	Single bearing, Brushless, Self-excited
Rated Output Prime Power (kVA)	40
Rated Speed (RPM)	1500
Rated Frequency (Hz)	50
Phase	3
Power Factor	0.8
Voltage Adjust Range	≥5%
Voltage Regulation NL-FL	≤±1%
Insulation Class / Temperature Rise	H / H
Protection Grade	IP23

Main Electrical Performance

Voltage				Frequency			
Stable Regulation Rate	Fluctuation	Recover Time	Instantaneous Regulating Rate	Stable Regulation Rate	Instantaneous Regulating Rate	Recover Time	Fluctuation
+/-2.5%	0.5%	1.5s	+20%/-15%	+5%	+/-10%	5S	0.5%

Control System

We use famous and reliable controller brands such as DEEPSEA, COMAP & SMARTGEN.

Protection		Parameter	
• Low Oil Pressure	• Over Crank	• Volt	• Oil Pressure
• Over Speed	• Over / Low Volt	• Current	• Oil Temp.
• Over Load		• Power	• Power Factor
• Over / Low Frequency		• Speed	• Running Time
• Battery Charge Failure		• Frequency	• Water Temp.
• High Water Temp.			• Battery Voltage



DSE 4520

Dimension & Weight

Canopy Type (DP 44kVA)

Lenght	2400mm
Width	1000mm
Height	1645mm
Weight	1435KG

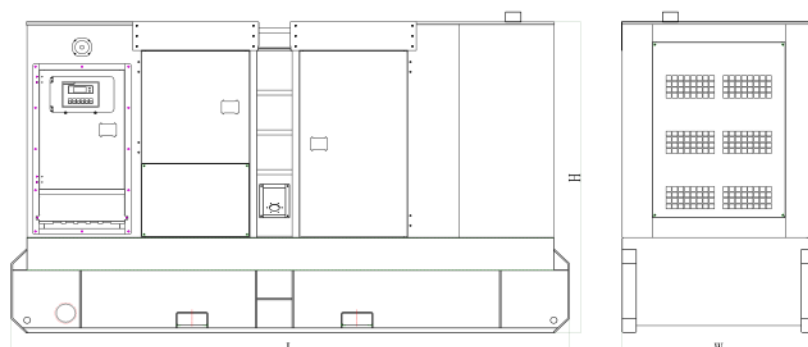

Open Type (DP 44kVA)

Lenght	N/A
Width	N/A
Height	N/A
Weight	N/A

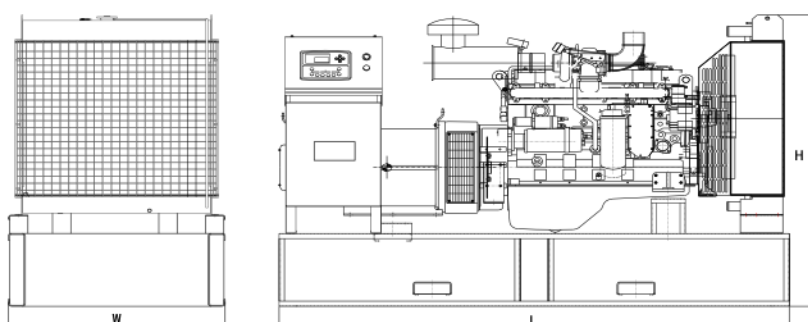

Generator Spare Parts Options

Generator Set

- ☐ Trailer generator set
- ☐ ABB MCCB circuit breaker
- ☐ Rental Type heavy-duty canopy
- ☐ Hot-dip galvanized skid base

Alternator

- ☐ PMG excitation
- ☐ Anti Condensation Heater
- ☐ RTD for alternator AC windings

For Cold Area

- ☐ Water heater
- ☐ Oil heater
- ☐ Fuel heater
- ☐ Electronic space heater

Exhaust System

- ☐ Residential exhaust silencer
- ☐ Stainless steel exhaust pipe
- ☐ Emission after-treatment system

Fuel System

- ☐ 12 hours base fuel tank
- ☐ 24 hours base fuel tank
- ☐ Double bunded base fuel tank
- ☐ Outside fuel tank

Auto System

- ☐ Remote Control panel
- ☐ ATS control cabinet
- ☐ Paralleling System