

DUNLOP PAWA 66kVA

50Hz 1500RPM 53kW/66kVA

General Features

- Low noise/super silent canopy design
- Forklift pockets available
- Residential silencer with flexible exhaust pipe
- MCCB & maintenance-free starting battery
- External fuel inlet, coolant drain, oil drain
- External power outlet distribution available
- Bunded base with 24-hour base fuel tank @75% load
- 50°C Radiator as standard spec;
- Radiator fan is driven by belt with safety guard
- Vibration isolators between engine/alternator and base frame
- All-round protection functions and safety labels
- User manual of engine, alternator, controller



Generator Ratings

Voltage	HZ	Phase	P.F (COS ϕ)	Prime Amps	Prime Ratings(kW/kVA)	Standby Ratings(kW/kVA)
380/220	50	3	0.8	91	48/60	55/66
400/230	50	3	0.8	87	48/60	55/66
415/240	50	3	0.8	83	48/60	55/66

- Prime Power: Continuous running at variable load for unlimited periods;
10% overload available for 1 hour in every 12 hours.
- Standby power: Continuous running at variable load in the event of a utility power failure;
No overload is permitted on these ratings.

Sales Promise

DUNLOP provides a full line of brand new and high quality products.

Each unit is strictly factory tested before delivery.

Warranty is according to below standard conditions, subject to the earlier one:

- 12 months after shipment
- 1000 accumulated running hours

Service and parts are available for the generator life time from **DUNLOP**

Engine

Manufacturer / Model	DCEC/4BTA3.9-G2
Air Intake System	4 Cycle, Turbocharger& Aftercooler
Fuel System	Direct Injection
Number of Cylinders / Cylinder Arrangement	4 in Line
Displacement (L)	3.9 L
Bore × Stroke (mm × mm)	102×120
Compression Ratio	17.3:1
Rated Speed (RPM)	1500
Standby Power @ Rated Speed (kW)	64
Speed Governor	Mechanical/Electrical
Fuel Consumption @ 100% Load (L/h)	15.0
Fuel Consumption @ 75% Load (L/h)	11.0
Fuel Consumption @ 50% Load (L/h)	8.0
Fuel Consumption @ 25% Load (L/h)	5.0
Total Oil Capacity (L)	10.9
System Voltage (V)	DC 24

Alternator

Compliance with GB755, BS5000, VDE0530, NEMAMG1-22, IED34-1, CSA22.2 and AS1359

Exciter Type	Single bearing, Brushless, Self-excited
Rated Output Prime Power (kVA)	60
Rated Speed (RPM)	1500
Rated Frequency (Hz)	50
Phase	3
Power Factor	0.8
Voltage Adjust Range	≥5%
Voltage Regulation NL-FL	≤±1%
Insulation Class / Temperature Rise	H / H
Protection Grade	IP23

Main Electrical Performance

Voltage				Frequency			
Stable Regulation Rate	Fluctuation	Recover Time	Instantaneous Regulating Rate	Stable Regulation Rate	Instantaneous Regulating Rate	Recover Time	Fluctuation
+/-2.5%	0.5%	1.5s	+20%/-15%	+5%	+/-10%	5S	0.5%

Control System

We use famous and reliable controller brands such as DEEPSEA, COMAP & SMARTGEN.

Protection		Parameter	
• Low Oil Pressure	• Over Crank	• Volt	• Oil Pressure
• Over Speed	• Over / Low Volt	• Current	• Oil Temp.
• Over Load		• Power	• Power Factor
• Over / Low Frequency		• Speed	• Running Time
• Battery Charge Failure		• Frequency	• Water Temp.
• High Water Temp.			• Battery Voltage



DSE 4520

Dimension & Weight

Canopy Type (DP 66kVA)

Lenght	2520mm
Width	1000mm
Height	1645mm
Weight	1535KG

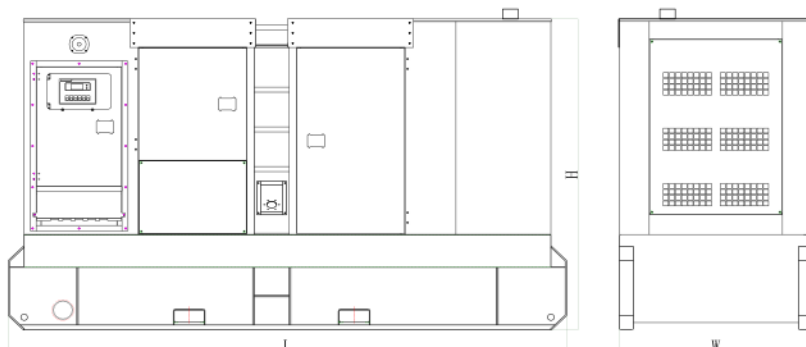

Open Type (DP 66kVA)

Lenght	N/A
Width	N/A
Height	N/A
Weight	N/A

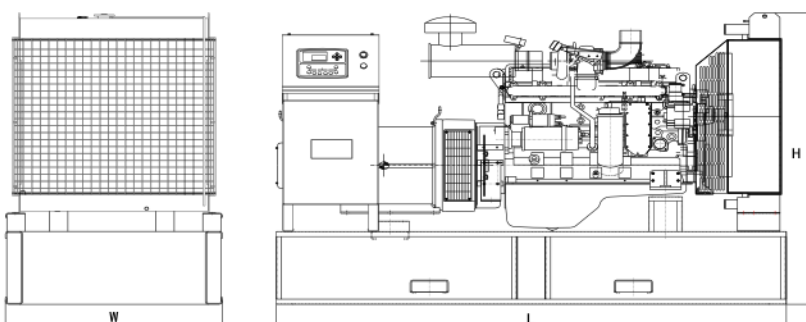

Generator Spare Parts Options

Generator Set	Alternator	For Cold Area
<input type="checkbox"/> Trailer generator set	<input type="checkbox"/> PMG excitation	<input type="checkbox"/> Water heater
<input type="checkbox"/> ABB MCCB circuit breaker	<input type="checkbox"/> Anti Condensation Heater	<input type="checkbox"/> Oil heater
<input type="checkbox"/> Rental Type heavy-duty canopy	<input type="checkbox"/> RTD for alternator AC windings	<input type="checkbox"/> Fuel heater
<input type="checkbox"/> Hot-dip galvanized skid base		<input type="checkbox"/> Electronic space heater
Exhaust System	Fuel System	Auto System
<input type="checkbox"/> Residential exhaust silencer	<input type="checkbox"/> 12 hours base fuel tank	<input type="checkbox"/> Remote Control panel
<input type="checkbox"/> Stainless steel exhaust pipe	<input type="checkbox"/> 24 hours base fuel tank	<input type="checkbox"/> ATS control cabinet
<input type="checkbox"/> Emission after-treatment system	<input type="checkbox"/> Double bunded base fuel tank	<input type="checkbox"/> Paralleling System
	<input type="checkbox"/> Outside fuel tank	

DUNLOP reserves the right to change specification without prior notice in line with our continuous product developemnt.
For more information, please contact your local Sales or email us
ian_hodge@dunlop-png.com.pg